

Micromax Controlled Droplet Applicator Assembly

Part Number Quantity Description

6034A	1	Fuse connector set, with 4 amp slow blow fuse (5747)
3402	1	Screw, 4BA x 3/8" ch/head slot
3667	1	Nut, 4BA nyloc
5880	1	Inner cup
6033	1	Mounting plate
4676	4	Screw, No 6 x 2" S/T pozi CSK AB
4687	1	Shim washer
4757	1	Washer, 5/16" x 7/8" flat
4836	1	Grub screw, 4BA slotted
4840	1	Label, Micromax

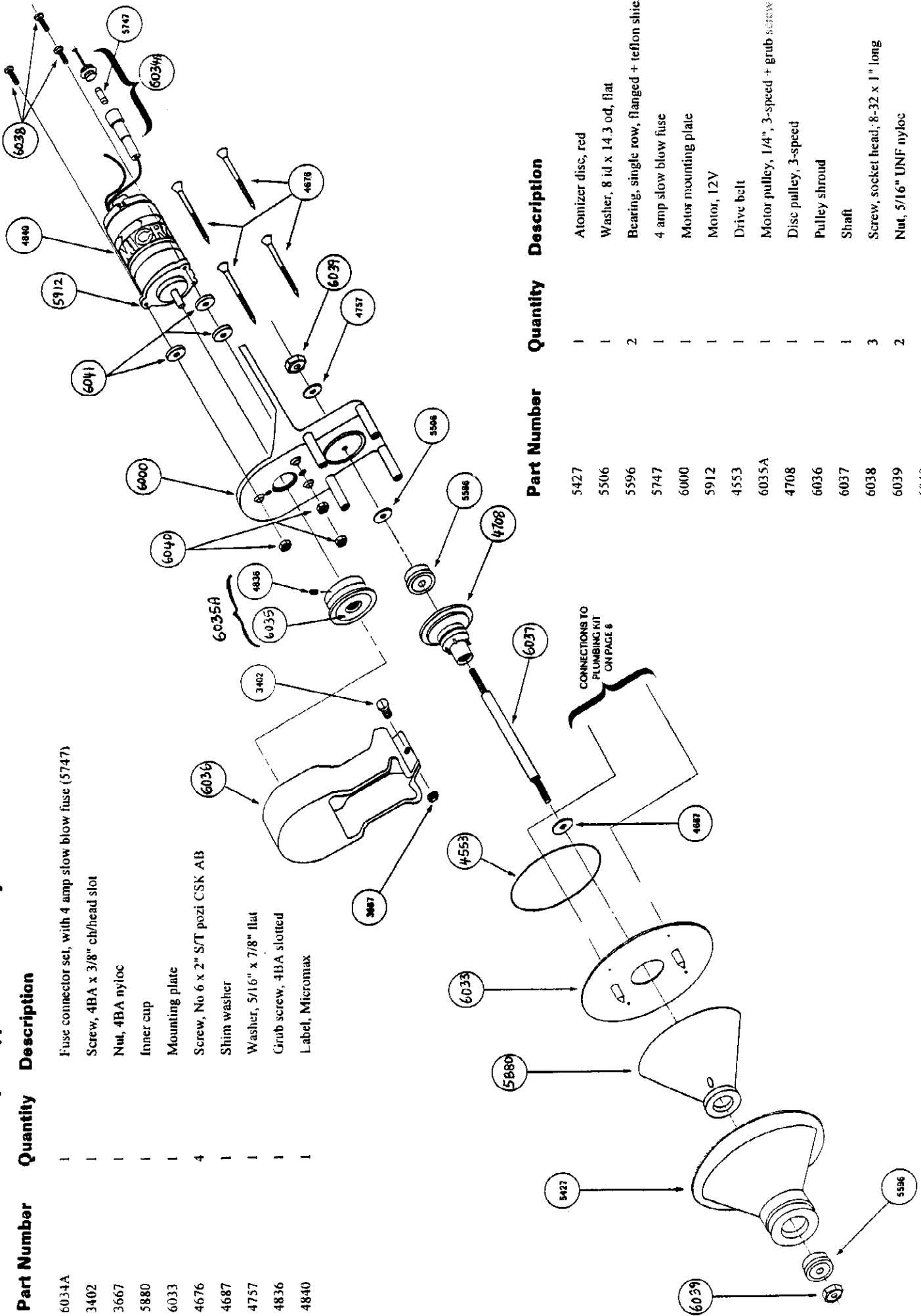

Part Number Quantity Description

5427	1	Atomizer disc, red
5506	1	Washer, 8 id x 14.3 od, flat
5596	2	Bearing, single row, flanged + teflon shields
5747	1	4 amp slow blow fuse
6000	1	Motor mounting plate
5912	1	Motor, 12V
4553	1	Drive belt
6035A	1	Motor pulley, 1/4", 3-speed + grub screw (4836)
4708	1	Disc pulley, 3-speed
6036	1	Pulley shroud
6037	1	Shaft
6038	3	Screw, socket head, 8-32 x 1" long
6039	2	Nut, 5/16" UNF nyloc
6040	3	Nut, 8-32 UNC nyloc
6041	3	Motor mount, rubber